



# M&M Manufacturing Company

## C-1200

Specifications:

- Galvanized Steel
- Wood Nailer
- Cant
- Insulation

Options:

- A. No Insulation
- B. No Nailer
- C. Aluminum
- D. Damper Tray
- E. Burglar Bars
- F. Metal Liner
- G. Flange Width

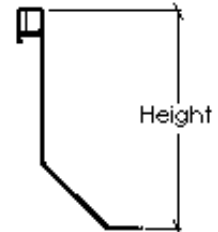
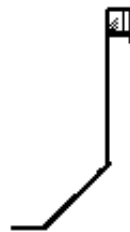
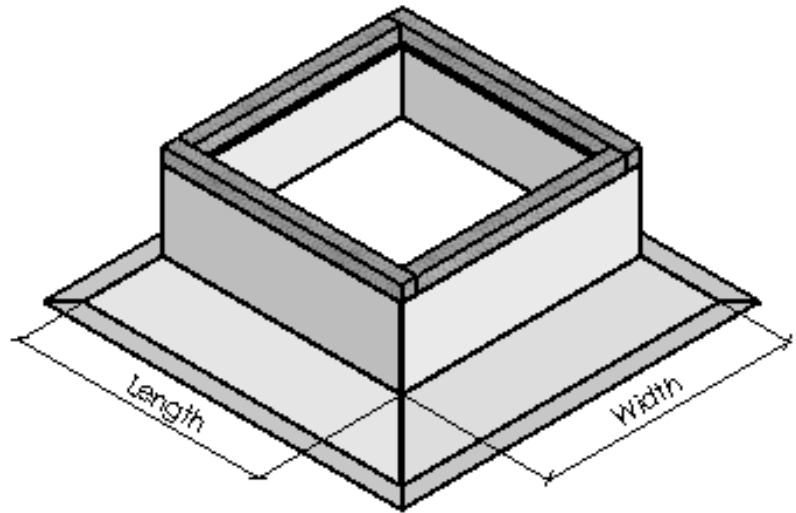

Customer: \_\_\_\_\_

\_\_\_\_\_

Project: \_\_\_\_\_

\_\_\_\_\_

Our Job#: \_\_\_\_\_

P.O. #: \_\_\_\_\_

Ship Date: \_\_\_\_\_

C-1200 Fan Curb:  
Canted Sides

Qty	*Gauge	Length	Width	Height	Cant Height	Options

\*18 gauge standard unless otherwise noted